

*PLEASE READ & Retain a copy of this portion for your records.*

### About Arts @ the Marina

Celebrate the arts with us! The South Essex Arts Association/Leamington Arts Centre proudly presents its 28th annual Arts @ the Marina outdoor arts and crafts show.

This two-day event held July 2 & July 3, 10am - 5pm at the scenic lakeside Leamington Municipal Marina and Rick Atkin Park, 100 Robson Road, features dozens of artisans on display, live local music, children's activities, food and refreshments. Arts @ the Marina is a family tradition and our volunteers and staff remain committed to the show's strong reputation of providing an authentic arts and craft show. Arts @ the Marina is THE major fundraiser for the SEAA/LAC, a not-for-profit charity.

### Exhibitor Eligibility

- This show is open to all forms of arts and crafts as well as food vendors.
- As this is a juried show, new applicants are to enclose photos or website/Facebook
- ABSOLUTELY NO manufactured goods are permitted and NO re-selling of goods unless explicitly approved in writing by the SEAA/LAC Arts @ the Marina committee.

### Terms + Set Up

- Numbered 12'x12' sites will be assigned to each exhibitor
- Priority is given to returning exhibitors, however SITE REQUESTS MUST BE RECEIVED BY APRIL 1. Site requests after April 1 will be booked in sequence received. Every attempt to accommodate site requests will be made, but not guaranteed.
- ALL EXHIBITORS must have a fire extinguisher (type 2A 10BC) on their site.
- ALL EXHIBITORS MUST CHECK-IN WITH ARTS @ THE MARINA VOLUNTEER BY 6pm Friday or by 9am Saturday PRIOR TO SET UP.
- Set Up Times: Friday, July 1 from 2:00pm to 9:00pm, Saturday, July 2 from 7:00am to 10:00am. ALL EXHIBITORS MUST BE SET UP BY 10am SATURDAY JULY 2.
- Space extension towards the back of the site is allowed for shade and extra seating or storage only, trees/landscape permitting. Space Extension towards the back for additional selling space is NOT permitted.
- Exhibitors may rent more than 1 space for sales area.
- Exhibitors may share a space if both exhibitors are approved by the jury.
- Limited Hydro outlets are available for an additional \$20 and are reserved on a first come first served basis. Priority given to food and beverage exhibitors.
- Exhibitor displays are to be totally self-sufficient, including persons or equipment for set-up and take-down. Please bring with you everything you may need: tables, chairs, display walls, canopy, debit machine, carts and dollies, extension cords, mats for cords, tape, zip ties, etc...
- All tents MUST be properly secured for severe weather (heavy rains and winds). Weights and/or small plastic tent pegs are NOT suitable. It is the exhibitor's responsibility to secure their tent properly to avoid damages to own tent and product as well as damages that could incur to neighbouring tents and displays. For your own protection, we recommend you to carry appropriate insurance coverage. Check with your agent. The South Essex Arts Association/ Leamington Arts Centre and the Municipality of Leamington are not responsible for loss or damages incurred by exhibitor participation.
- NO make-shift tents are permitted. Minimum 10'x10' tent. All tents must have side walls or tent must be left empty each night for security.
- Be careful to avoid staking into the underground sprinkles (marked with paint).
- ABSOLUTELY NO dismantling or removal of displays before 5:00pm Sunday. Early take-down could result in future show in-eligibility.
- ABSOLUTELY NO vehicles on the grass at any time. Loading and unloading are permitted from the parking lot or along Robson Rd. All vehicles must be moved off the road as soon as possible once unloaded/loaded.

### Breaks + Coffee

- Look for volunteers in the blue "LAC Artist Inside" t-shirt to assist or cover for short washroom breaks. Complimentary coffee will be served at approx. 9:30am on Sunday for all exhibitors.

### Overnight Security

- Event security will be provided from 6pm Friday July 1 to 7am Saturday, July 2 and from 6pm Saturday, July 2 to 7am Sunday, July 3.

### Exhibitor Parking

- Exhibitor parking is available across the street in the Robson Rd. North parking lot.
- Please SAVE the main front marina paved parking lot for event visitors.
- Absolutely NO Parking on the West gate drive. (Emergency fire route. Vehicles will be towed at the owners expense)

### Refunds + Cancellation

- Sorry, refunds will not be issued for any reason, as space is limited and exhibitors are juried. This is a rain or shine event.
- Should the event is canceled by the organizers due to COVID-19, credit or refund options will be available.

### Contact + Payment

- Optional online application form and PayPal checkout available on our website.
- Payment Options: PayPal or eTransfer to: [director@leamingtonartscentre.com](mailto:director@leamingtonartscentre.com) credit by phone, credit, debit cash in person.
- No Post-dated cheques. NSF Cheques will be subject to a \$25 NSF Fee.
- Cheques payable to:

**Leamington Arts Centre/South Essex Arts Association**

72 Talbot Street West, Leamington, ON N8H 1M4

[www.leamingtonartscentre.com](http://www.leamingtonartscentre.com) / [info@leamingtonartscentre.com](mailto:info@leamingtonartscentre.com) / 519-326-2711



Leamington Arts Centre

Create. Sustain. Celebrate.



# ARTS AT THE MARINA JULY 2 & 3

# 2022 exhibitor ENTRY FORM



# Application Form 2022



See Event Details on Reverse. Please submit this portion to the LAC

First Name \_\_\_\_\_ Last Name \_\_\_\_\_

Business Name \_\_\_\_\_ Business Website \_\_\_\_\_

Address \_\_\_\_\_ City/Town \_\_\_\_\_ Postal Code \_\_\_\_\_

Phone \_\_\_\_\_ E-mail \_\_\_\_\_ Exhibitor Vehicle Model \_\_\_\_\_

Description of Items to be Sold: \_\_\_\_\_ Items Are Original / I Am The Creator \_\_\_\_\_

Site Requests + Additional Info. (ie: same site as last year, etc.) \_\_\_\_\_

## Exhibitor Options

<b>Westside Exhibitor</b>	<b>\$145</b>
1 Hydro Outlet	n/a
<b>Parkside Exhibitor</b>	<b>\$175</b>
1 Hydro Outlet (limited)	\$30
<b>Roadside Exhibitor</b>	<b>\$185</b>
1 Hydro Outlet (limited)	\$30
<b>Food/Beverage Exhibitor</b>	<b>\$195</b>
1 Hydro Outlet	\$30
<b>Wine/Beer Exhibitor</b>	<b>\$195</b>
1 Hydro Outlet	\$30

**BONUS: LAC Membership**  
**Yes! Add me as an LAC Member**  
 No extra cost, no obligation, many benefit + discounts

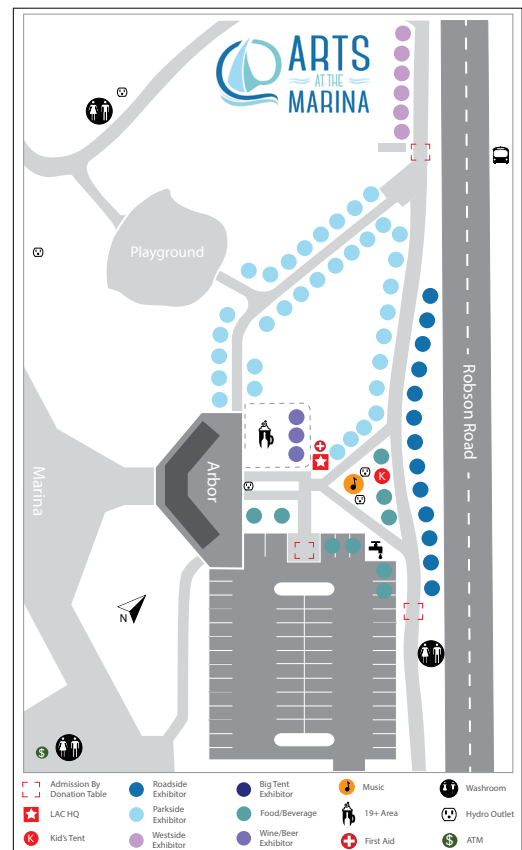

*These terms and conditions contain legal obligations. Please read these terms and conditions carefully before entering the event. LIMITATION OF LIABILITY: I/we hereby agrees to hold the South Essex Arts Association/Leamington Arts Centre, the Arts @ the Marina Committee, their officers, directors, employees and volunteers, and the Corporation of the Municipality of Leamington, harmless from any and all damage, expense or liability from any injury or damage to any person, including the general public, the exhibitor, its agents or employees or to the property of the exhibitor arising out of the exhibitor's participation in Arts @ the Marina. The South Essex Arts Association/Leamington Arts Centre will not be responsible for any loss or losses incurred by the exhibitor, as a result of fire, theft, water, accidents, weather, acts of God or other mishaps or incidents not specifically enumerated herein. Recognizing that Arts @ the Marina is run by a not-for-profit charitable organization, the exhibitor assumes all risks and responsibilities in participating in this event. ALL SALES ARE FINAL: There are no refunds of sites booked.*

Signature \_\_\_\_\_ Date \_\_\_\_\_

**OFFICE USE ONLY**

Payment Method + Date+ Receipt No. \_\_\_\_\_ Vendor Confirmation Sent \_\_\_\_\_ Site No. \_\_\_\_\_